

The following procedure will instruct you on how to effectively open the F58 bag for sample insertion.

1. Insert a finger into the slot to open the bag.



2. Pinch the sealed sides of the bag to hold it open.



3. Press the opposite, pinched sides of the bag together.

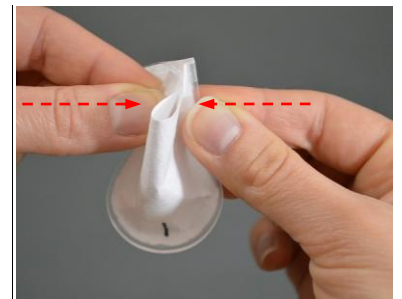

Side View

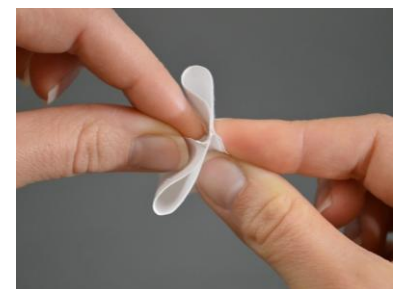

Top View

4. Place the bag on a flat surface with one of the sealed edges face down. Crease the two outside edges to form a V-shape in the material.

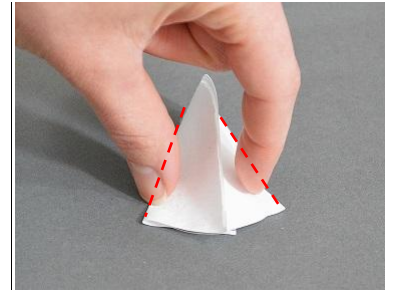

Front View

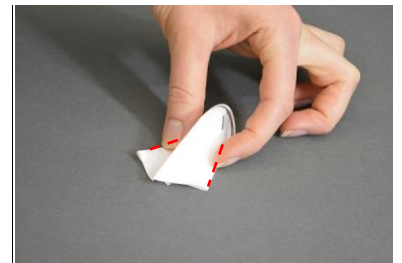

Side View

5. Place the bag into a bag weigh holder. The improved diamond shape of the bag will help it to remain open more effectively as sample is inserted.

